

POLK COUNTY CORNER RESTORATION FORM

SECTION 12 TOWNSHIP 6 S RANGE 9 W W.M. BLM ID 700500

CORNER ORIGINAL CLOSING CORNER TO SECTIONS 12 AND 13

DATE 10/29/2025 CORNER RESTORATION FIELD BOOK 202-09 PAGE 21

PREVIOUS RENEWALS / SURVEYS, ETC.

GLO R46-22 (ARMSTRONG, 1855); GLO R330-240 (FENTON, 1887); GLO R334-295 (MALONEY, 1889); TILLAMOOK COUNTY BK3-165; TILL. Co. B-534 / Polk Co. CS11246; TILL. Co. B-1230 / Polk Co. CS11815; TILL. Co. BK.6-293 / Polk Co. REG-63

CONDITION REPORT
 RENEWED
 UNRECORDED
 SURVEYED IN

MONUMENT AND ACCESSORIES FOUND (CONDITION AND SOURCE)

I FOUND A $\frac{5}{8}$ "x30" IRON ROD UP 6" PER POLK Co. CS11246 / TILL. Co. B-534 (SEE ALSO CORRESPONDING OREGON STATE PARKS MEMO TO FILE BY HOLLINGSWORTH, 6/12/1967, FILED AS TILL. Co. BK3-165). AN ORANGE CARSONITE POST BEARS SOUTH 2'; A STEEL T-POST BEARS NE'LY 2'.

THIS CORNER WAS ESTABLISHED BY JEFFERSON D. FENTON IN 1887. HE RETRACED THE EXISTING ARMSTRONG RANGE LINE FROM SOUTH TO NORTH, FINDING ALL OF ARMSTRONG'S ORIGINAL CORNERS. A PORTION OF T6S R9W WAS SUBDIVIDED IN 1880 BY SAMUEL G. CAUDLE, WHO FAILED TO FIND ARMSTRONG'S LINE. HE RAN SOUTH FROM JOHN MELDRUM'S 1871 NW CORNER OF T6S R8W, SETTING SECTION AND QUARTER CORNERS. FENTON FOUND CAUDLE'S CORNER TO SECTION 7,12,13,18 TO BE 3.17 CHAINS EAST AND 0.28 CHAINS NORTH OF ARMSTRONG'S CORNER. AT THE INTERSECTION OF CAUDLE'S LINE BETWEEN SECTIONS 12 AND 13 AND THE THE RANGE LINE, HE SET A CORNER FOR SECTIONS 12 AND 13 ONLY. FENTON DESTROYED CAUDLE'S CORNER.

- 33" (24") ROTTEN FIR STUMP BEARS S63°42'E (S60°E) 48.2' CTR (47.5'/72LK FENTON AND MALONEY; 75LK ARMSTRONG). SCRIBING "IR" VISIBLE ON FACE MATCHING 24" DIAMETER. (10" TREE FIRST MARKED IN 1855; 24" TREE RESCRIBED AS A GRAND RONDE INDIAN RESERVATION "GRIR" BEARING TREE BY FENTON IN 1887)
- 30" (28") ROTTEN FIR STUMP BEARS S18°47'W (S20°W) 33.1' CTR (31.7'/48LK). SCRIBING "BT" VISIBLE ON FACE MATCHING 28" DIAMETER. THE NOTES INDICATE THAT FENTON DESTROYED ARMSTRONG'S MARKINGS ON THE TREE (ORIGINALLY 10" IN 1855) FOR SECTION 13 AND THEN DESCRIBE IT BEING MARKED "T6S R9W S13 BT".
- 24" (10") ROTTEN HIGH-STUMP FIR BEARS S34°04'W (S33°45'W) 58.5' (57.9'). HEALED FACE, TAG, TIN TOP. (POLK Co. CS11246 / TILL. Co. B-1230); TILL. Co. BK3-165
- 35" (14") ROTTEN HIGH-STUMP FIR BEARS N83°29'W (N82°W) 113.4' (113.5'). HEALED FACE, TAG, TIN TOP. (POLK Co. CS11246 / TILL. Co. B-1230); TILL. Co. BK3-165

MONUMENT DETAIL

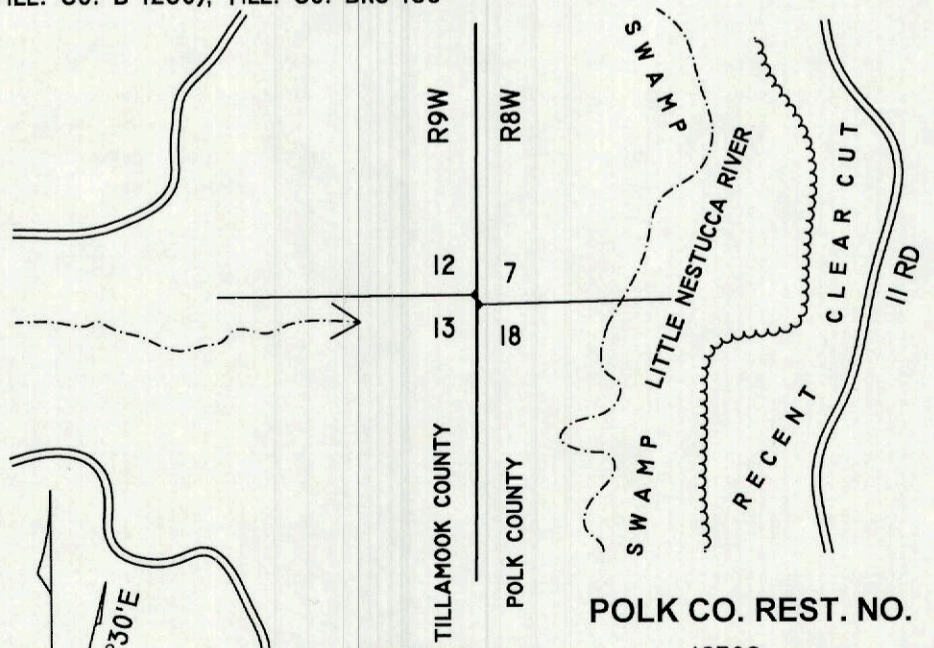
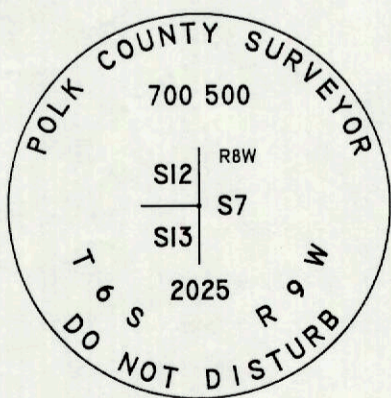

FIRM / AGENCY

POLK COUNTY SURVEYORS OFFICE
 820 SW ASH ST.
 DALLAS, OREGON 97338
 (503) 623-9287

WITNESSES JOSH HERZBERG

TONY MODE

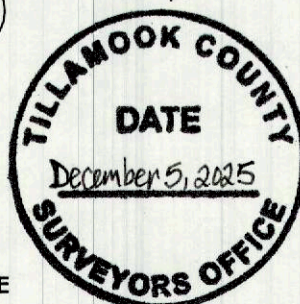

POLK CO. REST. NO.
12709

REGISTERED PROFESSIONAL LAND SURVEYOR
Darren Blackwell
 OREGON
 MARCH 8, 2022
 DARREN BLACKWELL
 97682

RENEWS 12/31/2025

MONUMENT SET (PROCEDURES AND DESCRIPTION)

IN PLACE OF THE 5/8" IRON ROD, I SET A 2 1/2"x30" ALUMINUM POST WITH A 3 1/4" ALUMINUM CAP AND A PINK PLASTIC BREAKAWAY MAGNETIC BASE, UP 6". I LAID THE OLD MONUMENT ALONGSIDE.

NEW ACCESSORIES

- 20" DOUG.-FIR BEARS S80°58'E 14.92'. SCRIBED "XX" ON UPPER BLAZE AND "BT" ON LOWER BLAZE. NAIL LEFT SIDE CENTER.
- 8" DOUG.-FIR BEARS S80°14'W 18.44'. SCRIBED "T6S R9W S13 BT". NAIL LEFT SIDE CENTER.
- 7" GRAND FIR BEARS N05°45'W 20.56'. SCRIBED "T6S R9W S12 BT".
- 5/8"x30" IRON ROD WITH YELLOW PLASTIC CAP "POLK COUNTY SURVEYOR" BEARS N25°36'38"E 25.08', DOWN 4".

THE CORNER TO SECTION 7 AND 18 ONLY BEARS S00°28'09"W (S01°03'05"W) 18.43' (18.44'). POLK Co. CS11815 / TILL. Co B-1230)

THE CORNER LIES ON A FLAT AREA WEST OF A BRUSHY SWAMP IN MIXED AGE TIMBER.

BASIS OF MEASURED BEARINGS OREGON COORDINATE REFERENCE SYSTEM, SALEM ZONE GRID. CONVERGENCE ANGLE (SALEM ZONE) IS -00°27'14".

COORDINATES

COORDINATES WERE OBTAINED BY TRAVERSING FROM TEMPORARY GNSS CONTROL. COORDINATES ARE PROJECTED TO THE FOLLOWING COORDINATE SYSTEMS, NAD83(2011) EPOCH 2010.00. UNITS IN INTERNATIONAL FEET.

SPCS83 OREGON NORTH (3601)

N 524136.45 E 7369121.72

OCRS SALEM ZONE

265133.97 E -1661.81

OCRS OREGON COAST ZONE

N 1323823.28 E 526174.52

NOTES

1 -SET WITNESS TAGS, PAINTED SCRIBED FACES RED, AND PAINTED RED BANDS ON ALL LIVE BEARING TREES, UNLESS NOTED.

2 -ALL DISTANCES TO NEW BEARING TREES ARE MEASURED TO A 60D MAG NAIL AND POLK Co. SURVEYOR BRASS WASHER, RIGHT SIDE AND CENTER UNLESS OTHERWISE NOTED.

FIRM / AGENCY

POLK COUNTY SURVEYORS OFFICE
820 SW ASH ST.
DALLAS, OREGON 97338
(503) 623-9287

WITNESSES JOSH HERZBERG

TONY MODE

Page 2 of 2

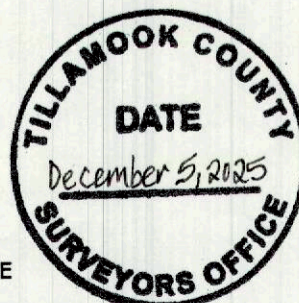

POLK CO. REST. NO.
12709

REGISTERED
PROFESSIONAL
LAND SURVEYOR

Darren Blackwell
OREGON
MARCH 8, 2022
DARREN BLACKWELL
97682

RENEWS 12/31/2025